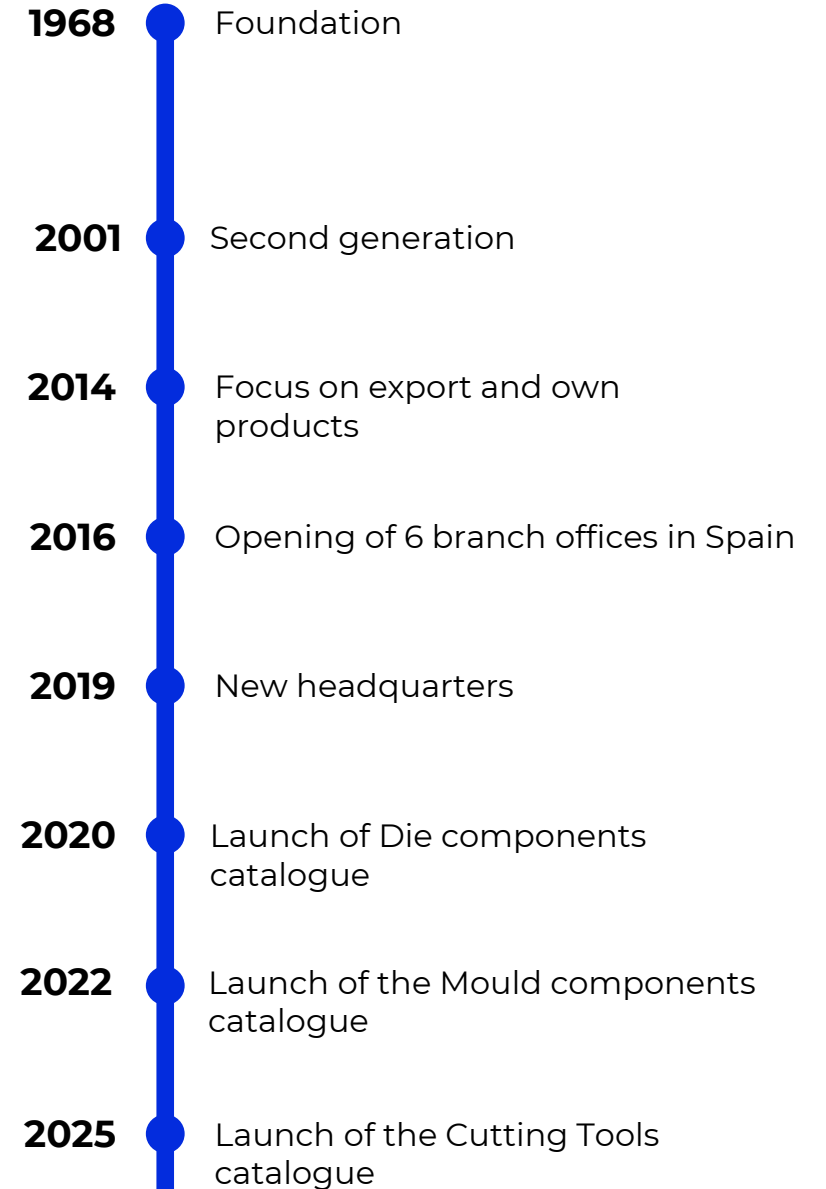

ROYME®

# We are experience

- 
- 1968** Foundation
  - 2001** Second generation
  - 2014** Focus on export and own products
  - 2016** Opening of 6 branch offices in Spain
  - 2019** New headquarters
  - 2020** Launch of Die components catalogue
  - 2022** Launch of the Mould components catalogue
  - 2025** Launch of the Cutting Tools catalogue

# We are a team

Take a quick tour of  
Royme with our latest  
video

[Watch video](#)



**+ 65**  
EMPLOYEES



**10**  
BRANCH OFFICES



**+ 25.000**  
ITEMS IN STOCK



**+ 100.000**  
CATALOGUED  
REFERENCES



**+ 2.000**  
CUSTOMERS



**+ 40**  
COUNTRIES



**+ 600**  
ORDERS PER DAY



# We are service

Technical and sales office specialized in components for **Die and Moulds**



Ask us about any market code — **we'll know how to translate it.**



We will always give you an **answer**, whether it's a catalogue product or a **special part made to drawing.**



We'll **solve** your problem by offering the solution that best fits your price and delivery needs.



**In-house workshop** capable of manufacturing punches, dies, and ejectors within 24 hours. Over **950 urgent orders** handled every year.

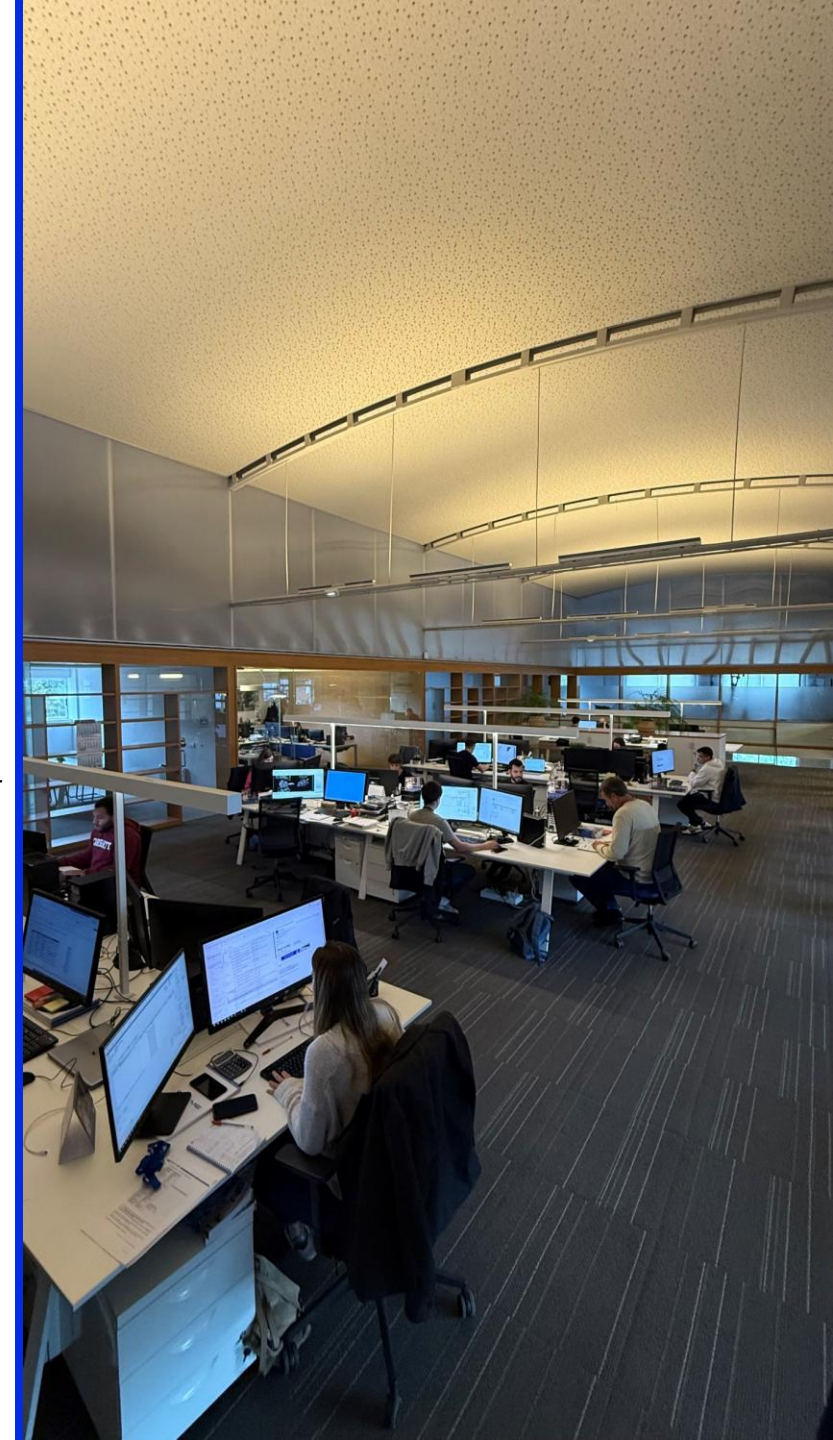

# We are quality

SPRINGS

[Catalogue](#)



# We are quality

## GUIDING ELEMENTS

Die  
Mould



# We are quality

## AUTO STANDARDS

[Catalogue](#) 



## CAMS

[Catalogue](#) 



# We are quality

**PUNCHES & BUTTONS**

[Catalogue](#) 



# We are quality

## EJECTION AND DEMOULDING

[Catalogue](#) 



# We are quality

## MOLD COMPONENTS

[Catalogue](#) 

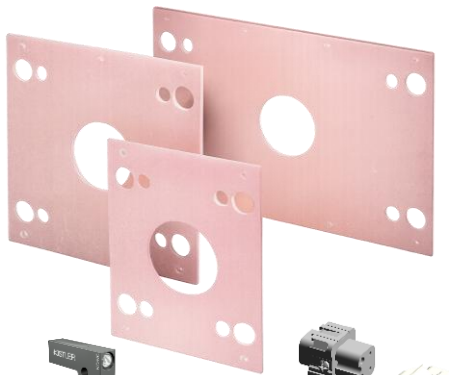
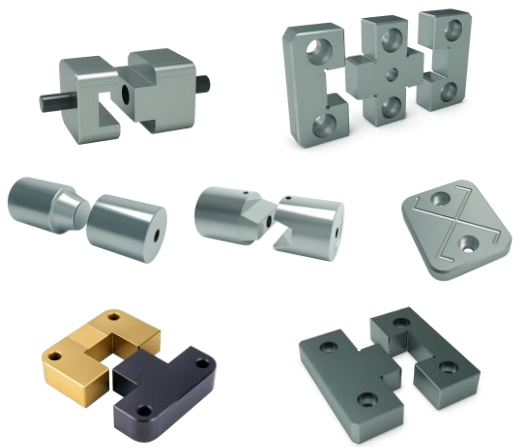

# We are quality

## TRACEABILITY

Die   
Mould 



# We are quality

## TRANSPORT

[Catalogue](#) 

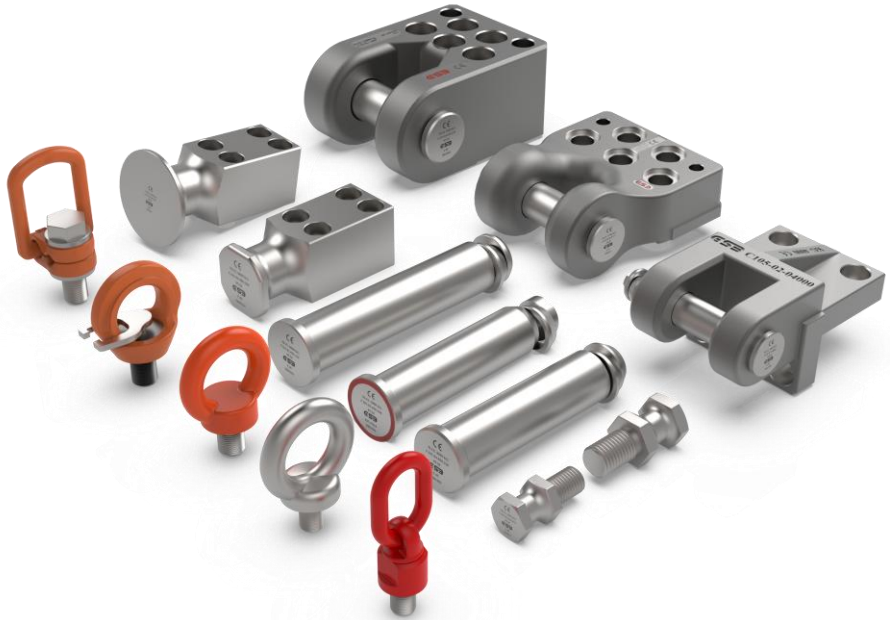

## STEELS AND PLATES

[Catalogue](#) 

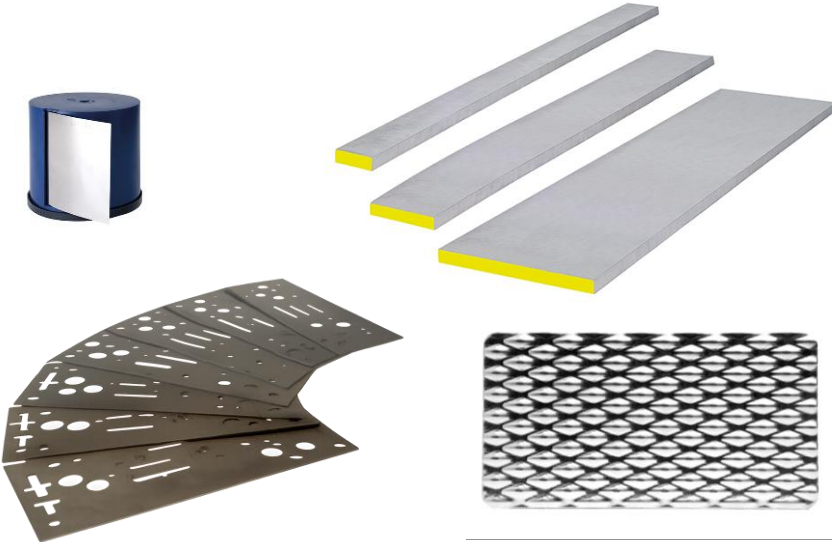

# We are quality

## ACCESSORIES

[Catalogue](#) 



# We are quality

## CUTTING TOOLS

[Catalogue](#) 



## POLISHING

[Catalogue](#) 



# We are quality

## SPECIAL PARTS

[Catalogue](#) 



Custom-designed parts in a wide variety of materials and coatings, from carbon steels and high-speed steels to high-performance options such as powder metallurgy steels and hard metals in different grades.

# We are guarantee

Our collaborators



# We are trust



The image features a white background with three large, solid blue geometric shapes in the corners: a trapezoid in the top-left, a triangle in the top-right, and a triangle in the bottom-left.

**We are ROYME®**